

10-12LM & E14 lines

Deepwell Borehole

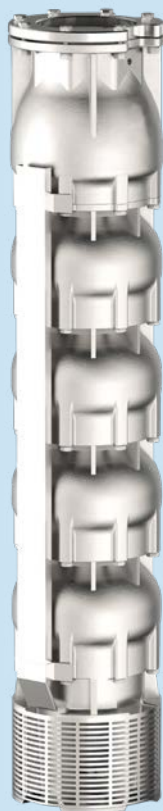

10LM line



12LM line



E14

Submersible multistage centrifugal pumps for 10", 12" and 14" wells. Check valve built into the delivery outlet. Pump flange for coupling with motors are made according to NEMA standards. Most common applications are civil and agricultural. All components are made of stainless steel with lost wax Microfusion technology, the standard material is AISI 304 stainless steel, alternatively the following materials are available on request: AISI 316 Steel, Duplex steel, AISI 904L Steel. Bushing bearings and wear-rings made of sand abrasion-resistant rubber, reverse-Thrust ring in PTFE/Graphite.

General operating data:

- Capacity up to 860 m³/h
- Pressure up to 800 m
- Hydraulic efficiency 10", up to 84,0%
- Hydraulic efficiency 12", up to 82,5%
- Hydraulic efficiency 14", up to 82,3%
- Pressure up to 80 bar
- Powers up to 400 kW
- Rotation speed up to 3600 rpm
- Maximum depth: 350 m
- Maximum quantity of permitted sand: 100 gr/m³
- Drinking water compatibility according to DM174 MEI >= 0,4 (EU directive No.547/2012)
- Performance tolerance: ISO9906-3B.

Construction features

Suction and delivery outlet	AISI 304 (LMS) AISI 316 (LMX - EX) Duplex (LMD - ED) Cast iron (E)
Valve	AISI 304 (LMS) AISI 316 (LMX - EX) Duplex (LMD - ED) Cast iron (E)
Impellers and diffusers	AISI 304 (LMS) AISI 316 (LMX - EX) Duplex (LMD - ED) Cast iron (E)
Upper bushings	NBR rubber
Shaft pump side	AISI 304 (LMS) AISI 316 (LMX) Duplex (LMD) AISI 431 (E - EX - ED)
Quantity of sand in the water	max 100 g/m ³



Motor 50 Hz - 2900 rpm				Q									
TYPE	Power		400 V	I/min	0	1333	2667	4000	5333	6667	8000	8500	9667
	HP	kW		A	I/sec	0	22,2	44,5	66,7	88,9	111,1	133,3	141,8
			m ³ /h		0	80	160	240	320	400	480	510	580
E 14 A/1 D	90	66	126,0	H[m]	71,8	66,5	62,5	58,7	54,4	49,0	41,6	38,2	
E 14 A/1 C	100	75	143,2		76,8	71,7	67,5	63,8	59,6	54,6	47,9	45,0	39,0
E 14 A/1 B	125	92	175,1		85,1	79,9	75,6	71,8	67,8	63,3	57,7	55,1	48,2
E 14 A/1 A	150	110	211,0		97,1	90,8	85,5	80,4	75,6	70,7	65,4	63,0	57,6
E 14 A/1 Nom.	175	130	245,3		108,6	99,3	92,3	87,0	82,5	78,0	73,0	70,8	64,1
E 14 A/2 D	175	130	245,3		143,5	133,0	125,0	117,4	108,8	98,0	83,2	76,4	
E 14 A/2 C	200	150	277,2		153,6	143,4	135,0	127,6	119,1	109,1	95,8	90,0	78,0
E 14 A/2 B	250	185	342,2		170,2	159,8	151,2	143,6	135,6	126,5	115,4	110,2	96,4
E 14 A/2 A	300	220	430,0		194,3	181,6	171,0	160,8	151,2	141,4	130,8	126,0	115,2
E 14 A/2 Nom.	340	250	481,0		217,3	198,6	184,6	174,0	165,0	156,0	146,0	141,6	128,2

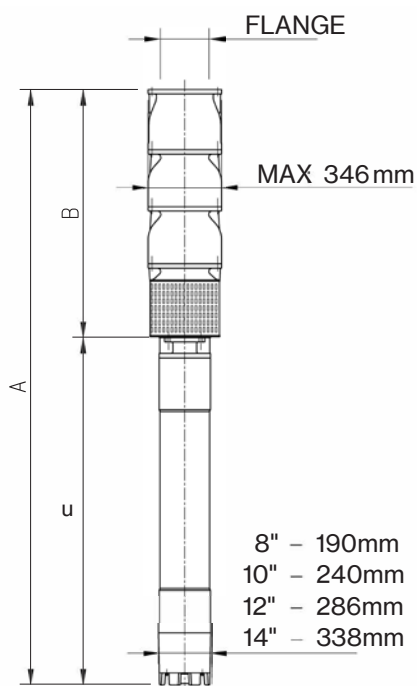

Motor 50 Hz 2900 rpm	DIMENSIONS (mm)			Weight (kg)	
TYPE	A	B	C	M	P
E 14 A/1 D	2237	935	1302	214	184
E 14 A/1 C	2318	935	1383	230	184
E 14 A/1 B	2518	935	1583	270	184
E 14 A/1 A	2668	935	1733	300	184
E 14 A/1 Nom.	2569	935	1634	385	184
E 14 A/2 D	2809	1175	1634	385	260
E 14 A/2 C	2909	1175	1734	415	260
E 14 A/2 B	3159	1175	1984	480	260
E 14 A/2 A	3285	1175	2110	700	260
E 14 A/2 Nom.	3455	1175	2280	775	260

Max Eff. % =	82,3
Max KW / St.: D = - D.230mm =	64,9
Max KW / St.: C = - D.238mm =	74,0
Max KW / St.: B = - D.251mm =	90,8
Max KW / St. A = - D.268mm =	109,1
Max KW / St. Nom. - D.276mm =	119,3

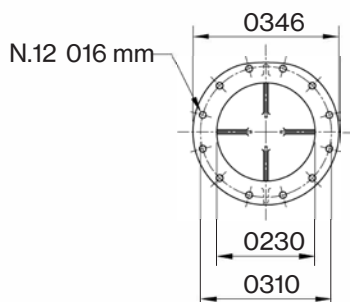

Q (flow)	25%	50%	75%	100%
NPSH (m)	5,8	6,4	9,4	15,3

"D" Pump shaft in Duplex

E14 A

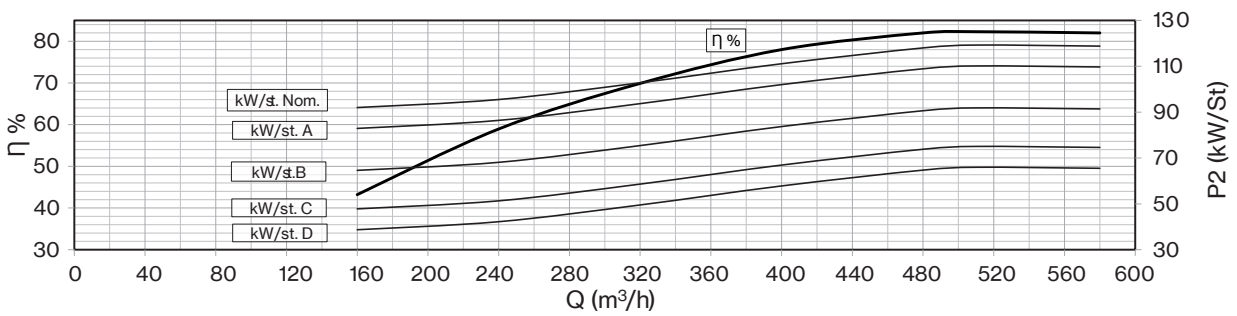
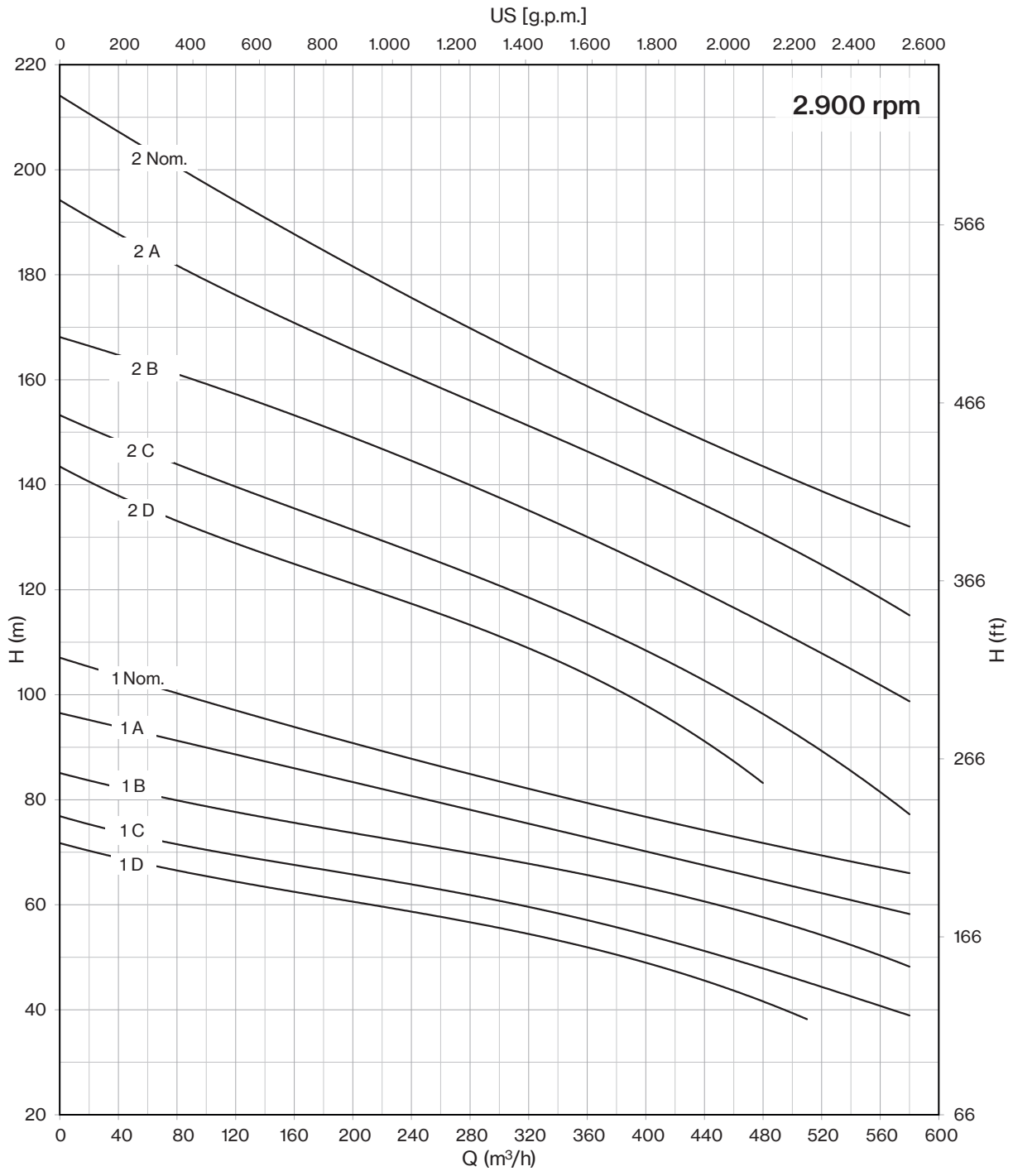

Motor 50 Hz - 2900 rpm				Q									
TYPE	Power		400 V	I/min	0	1333	4000	5333	6667	9000	10000	12500	14333
	HP	kW		A	I/sec	0	22,2	66,7	88,9	111,1	150,0	166,7	208,3
			m ³ /h		0	80	240	320	400	540	600	750	860
E 14 B/1 C	125	92	175,1	H[m]	73,5	72,5	68,0	63,5	57,8	44,0	36,5	14,0	
E 14 B/1 B	150	110	211,0		80,4	79,5	75,0	71,5	66,0	53,5	46,7	26,5	
E 14 B/1 A	175	130	245,3		87,0	84,0	79,0	77,0	73,8	66,0	61,5	45,5	29,0
E 14 B/1 Nom.	200	150	277,2		100,8	97,4	90,4	86,9	82,9	74,2	69,0	53,9	38,4
E 14 B/2 C	250	185	342,2		147,0	145,0	136,0	127,0	115,6	88,0	73,0	28,0	
E 14 B/2 B	300	220	430,0		160,7	159,0	150,0	143,0	132,0	107,0	93,4	53,0	
E 14 B/2 A	400	300	551,0		174,0	168,0	158,0	154,0	147,6	132,0	123,0	91,0	58,0
E 14 B/2 Nom.	400	300	551,0		201,6	194,8	180,8	173,8	165,8	148,4	138,0	107,8	76,8

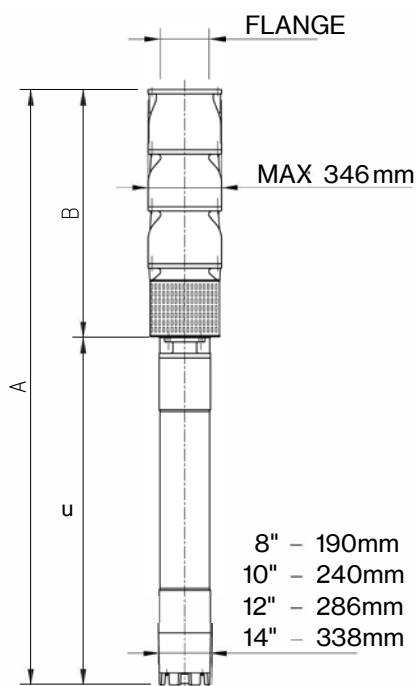

Motor 50 Hz 2900 rpm	DIMENSIONS (mm)			Weight (kg)	
TYPE	A	B	C	M	P
E 14 B/1 C	2488	905	1583	270	184
E 14 B/1 B	2638	905	1733	300	184
E 14 B/1 A	2539	905	1634	385	184
E 14 B/1 Nom.	2639	905	1734	415	184
E 14 B/2 C	3159	1175	1984	480	260
E 14 B/2 B	3285	1175	2110	700	260
E 14 B/2 A	3455	1175	2280	775	260
E 14 B/2 Nom.	3455	1175	2280	775	260

Max Eff. % =	78,6
Max KW / St.: C - D.240mm =	91,8
Max KW / St.: B - D.250mm =	109,7
Max KW / St. A. - D.259mm =	129,6
Max KW / St. Nom. - D.274mm =	149,6

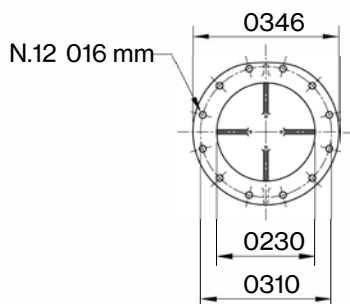

Q (flow)	25%	50%	75%	100%
NPSH (m)	6	6,4	8,6	16,3

"D" Pump shaft in Duplex

E14 B

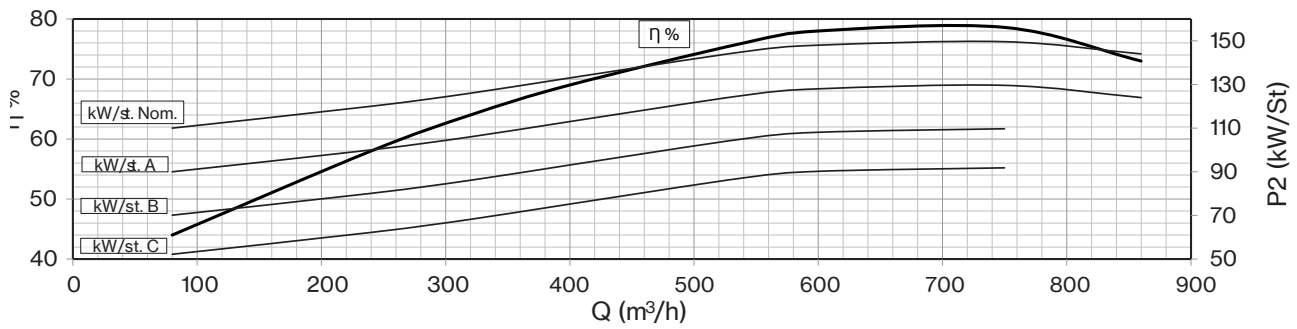
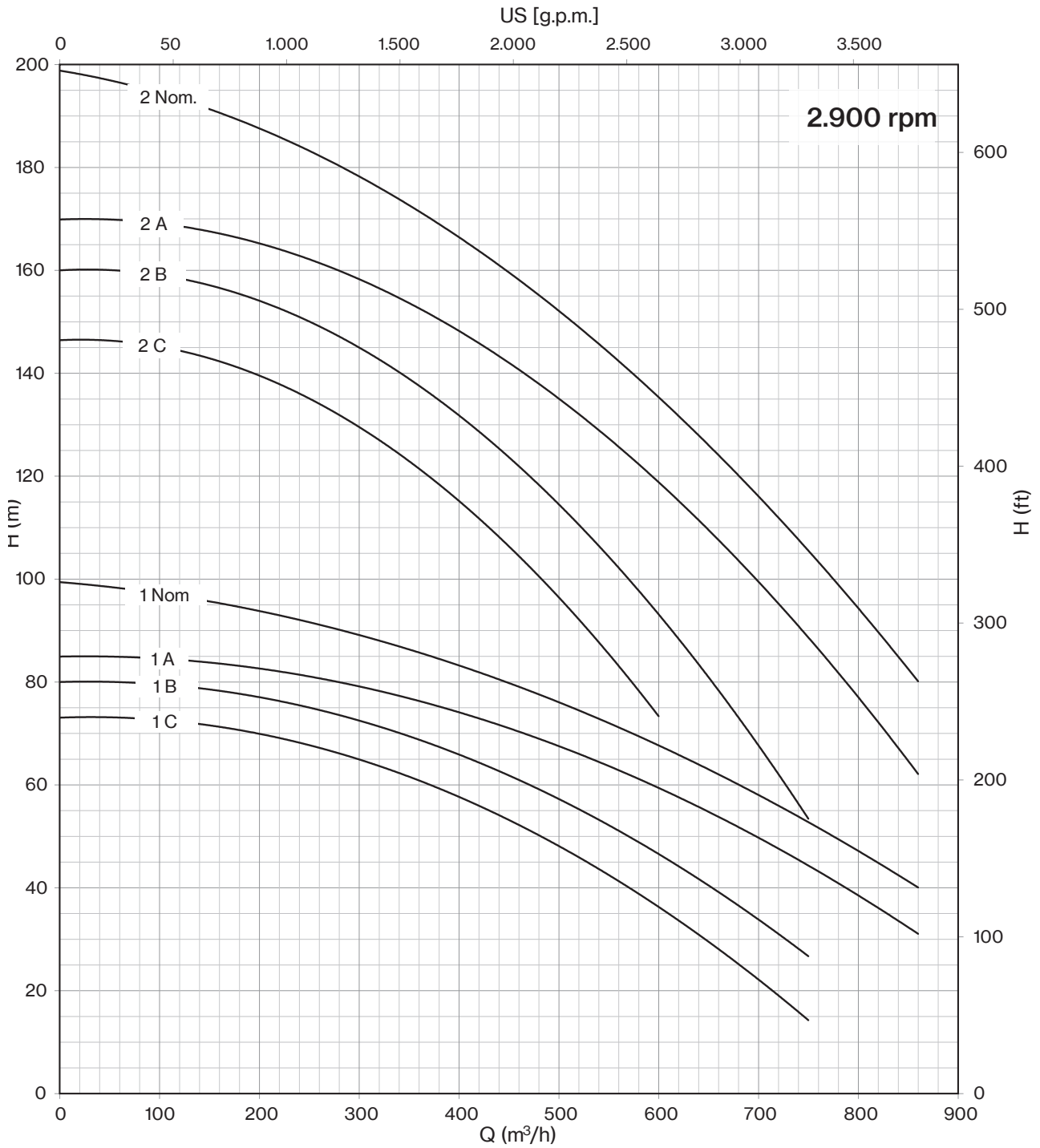

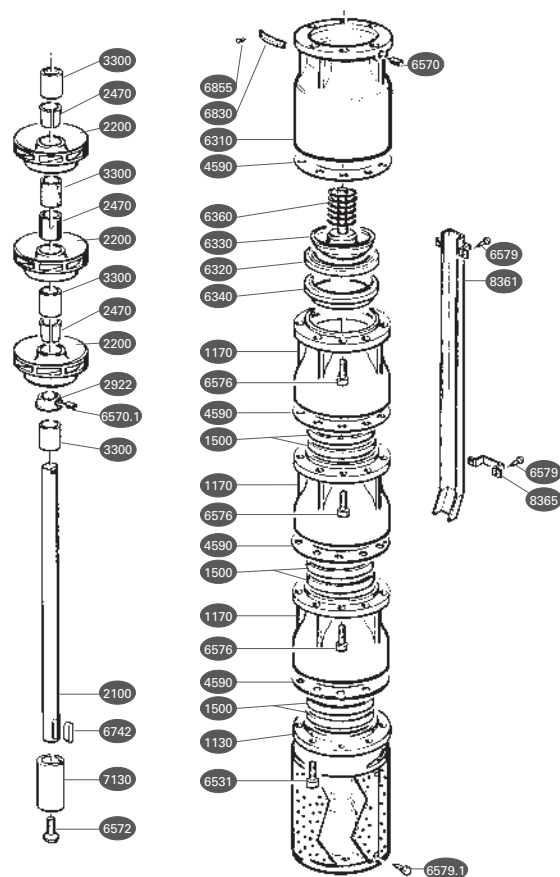

N° CODE.	DESCRIPTION	MATERIAL	(*) Q.TY
1130	Support	Cast iron	
1170	Diffuser	Cast iron	
1170.1	Lat Diffuser	Cast iron	
1500	Wear ring	Rubber	1 x stage
2100	Shaft	Stainless steel	
2200	Impeller	Cast iron	1 x stage
2470	Bushing	Steel	1 x stage
2922	Sandguard	Brass	
3300	Bearing	Steel - rubber	1 x stage
4590	Gland	Guarnital	1 x stage
6310	Valve body	Valve body / Cast Iron	
6320	Valve housing	Rubber	
6330	Washer	Stainless steel	
6340	Housing ring	Cast iron	
6360	Spring	Stainless steel	
6531	Strainer	Stainless steel	
6570	Screw	Stainless steel	
6570.1	Screw	Stainless steel	
6572	Screw	Stainless steel	
6576	Screw	Stainless steel	
6579	Screw	Stainless steel	
6579.1	Screw	Stainless steel	
6742	Key	Stainless steel	
6830	Label	Stainless steel	
6855	Pin	Stainless steel	
7130	Joint	Stainless steel	
8361	Sheat	Stainless steel	
8365	Cable guard clamp	Stainless steel	

* Recommended spare parts quantity