

2PLUS A / SA



Pressurisation units with 2 self-priming pumps of PLUS A or PLUS SA series on a single skid, connected in parallel by suction and delivery manifolds.

They are available in fixed speed version with electronic control panel or in variable speed version with EPIC inverters for constant pressure. The key characteristics of these systems are their reliability, user-friendly operation, and low maintenance needs. Installation of a pressure tank is required.

Booster set features

Suction manifold	galvanized steel with non-return and isolation valves
Delivery manifold	galvanized steel with pressure gauge and isolation valves, two connectors in the delivery manifold for direct installation of pressure tanks up to 24 lt
Base frame	galvanized steel
Fixed speed	electronic control panel EQ2SM(T) and two pressure switches
Variable speed	inverter EPIC on each pump and two pressure sensors
Pressure tanks	available on request as accessories

Pump features

Pump body, mechanical seal housing	stainless steel AISI 304
Motor bracket	aluminum
Impellers, diffusers	Noryl®
Mechanical seal	ceramic-graphite-EPDM
Motor shaft	stainless steel AISI 303
Liquid temperature	-5 ÷ +35 °C
Operating pressure	max 7 bar
2 poles induction motor	3~ 230/400V - 50Hz 1~ 230V - 50Hz
Motor insulation class	F
Motor protection degree	IPX4

PERFORMANCE

TARGET (2 pumps)		MODEL			P2 NOMINAL		Q (m³/h - l/min)																
		FIXED SPEED		VARIABLE SPEED			0	1,2	2,4	3,6	4,8	7,2	8,4	9,2	9,6	12,0	14	15,6					
l/min	bar	1- 230V	3- 400V	1- 230V-in 3- 230V-out	HP (x2)	kW (x2)	H (m)																
							0	20	40	60	80	120	140	153,4	160	200	233	260					
80	3	2P3A-90/4	2P3A-90/4T	2P3A/E-90/4T	0,9	0,66	40,8	38,3	35,1	31,8	29,9	19,8	15,0										
		2P3SA-90/4	2P3SA-90/4T	2P3SA/E-90/4T			43,0	41,0	38,3	35,0	31,3	22,3	17,2	13,5									
100		2P3A-100/5	2P3A-100/5T	2P3A/E-100/5T	1	0,75	52,2	48,9	45,1	40,8	36,0	25,4	19,8	15,0									
		2P3SA-100/5	2P3SA-100/5T	2P3SA/E-100/5T			54,0	52,1	48,8	44,9	40,2	29,0	22,0	16,8									
160		2P5A-120/4	2P5A-120/4T	2P5A/E-120/4T	1,2	0,9	45,3	44,2	42,8	41,3	39,6	35,6	33,4	31,7	30,8	24,0	15,0						
		2P5SA-120/4	2P5SA-120/4T	2P5SA/E-120/4T			44,5	43,3	42,1	41,0	40,0	36,4	34,3	32,8	32,0	26,2	18,5	13,5					
200	2P5A-150/5	2P5A-150/5T	2P5A/E-150/5T	1,5	1,1	56,8	55,9	54,6	53,0	51,0	46,1	43,2	41,2	40,1	33,0	24,0	15,0						
	2P5SA-150/5	2P5SA-150/5T	2P5SA/E-150/5T			56,0	52,2	54,0	52,4	50,5	46,4	43,9	42,0	41,0	33,8	23,8	16,5						

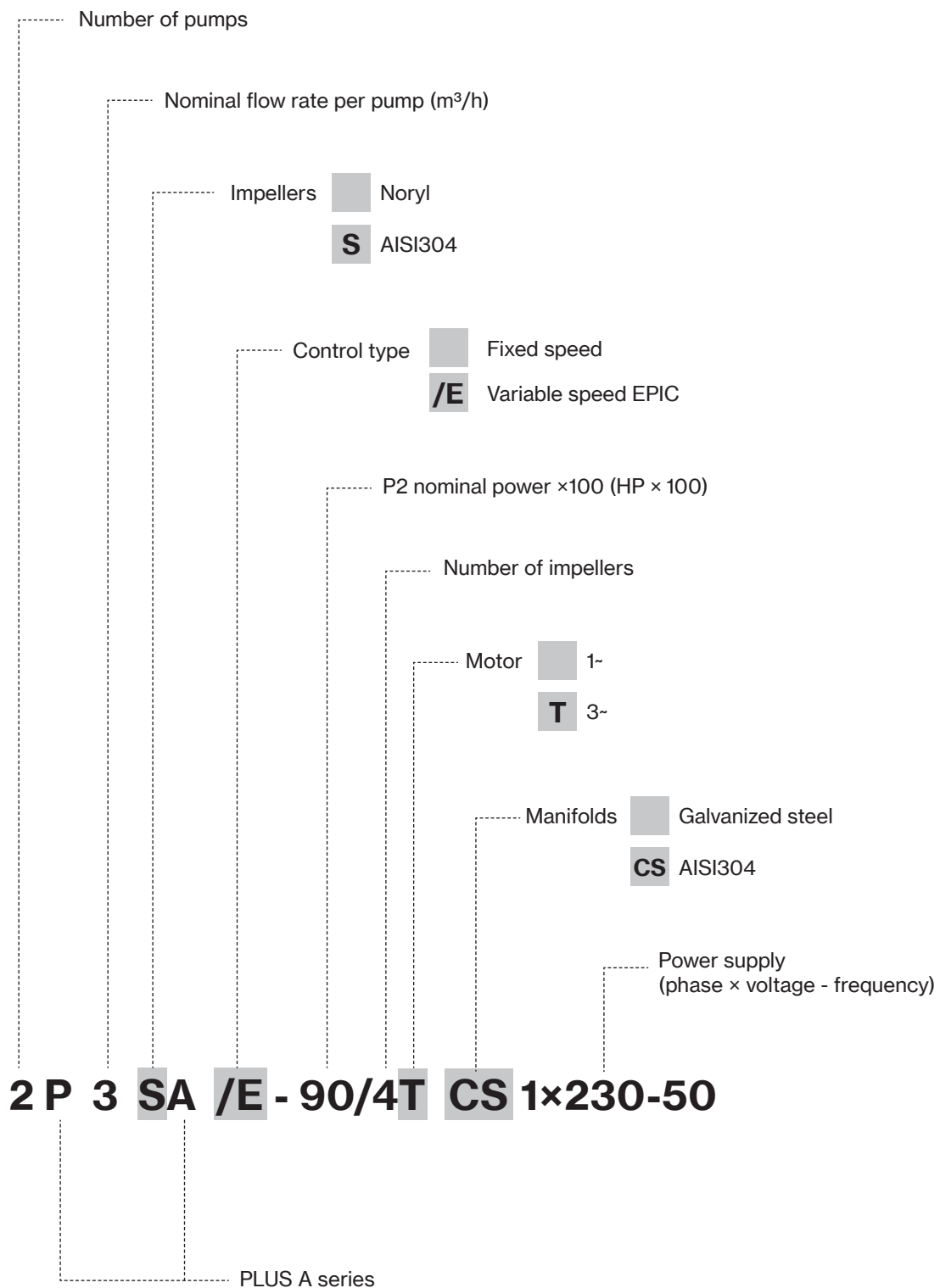

Performance data and curves

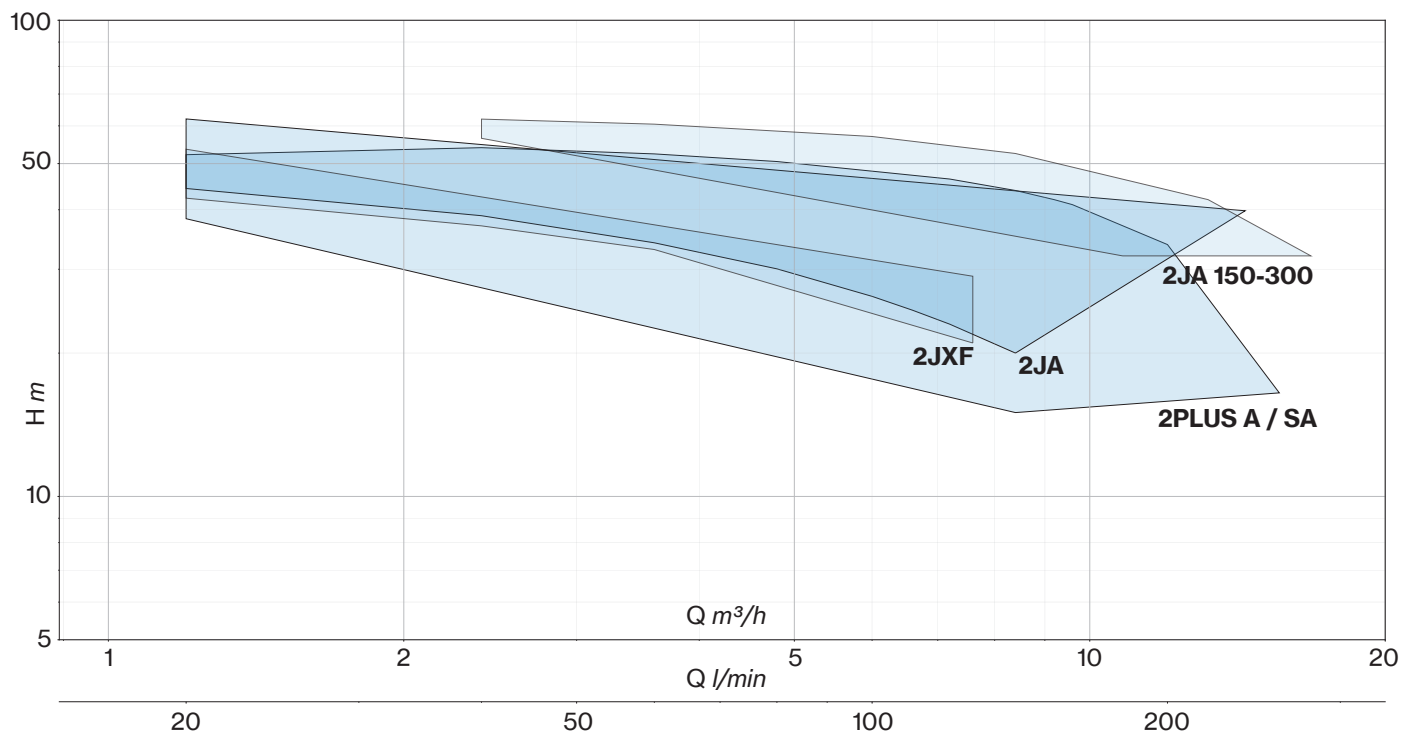

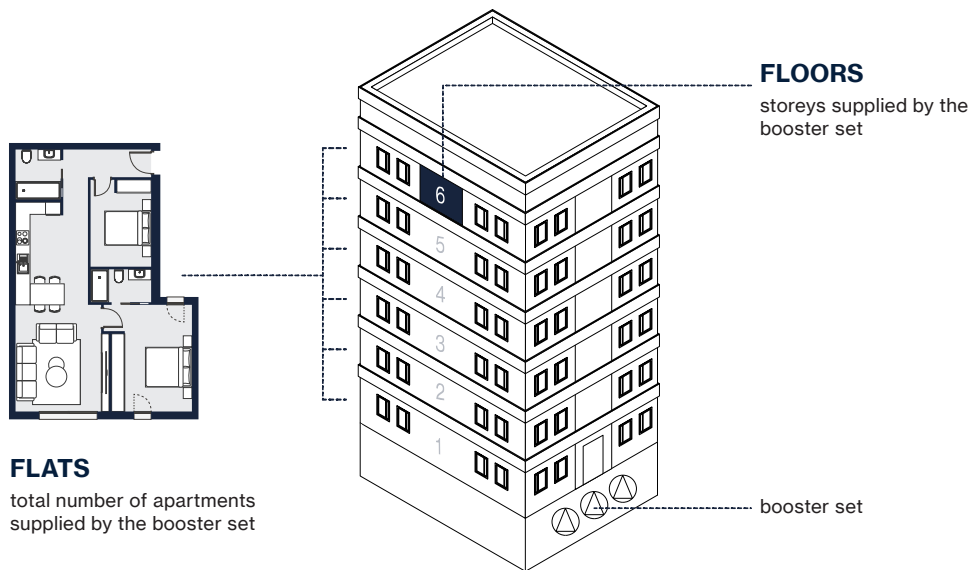

FLATS		FLOORS	PLUS A series	PLUS SA series	JA/JAM series	JXM series	JA 150-300 series
1 duty and 1 standby pumps	2 duty pumps						
1	1-2	1-2	2P3A_-90/4_	2P3SA_-90/4_	2JA_106N_	2JXF_106N_	-
		3	-	2P3SA_-90/4_	2JA_106N_	-	-
2	3-4	1-2	2P3A_-100/5_	2P3SA_-90/4_	2JA_126_	2JXF_126_	-
		3	2P3A_-100/5_	2P3SA_-100/5_	2JA_146_	2JXF_146_	-
		4	-	2P3SA_-100/5_	2JA_146_	-	-
		5	-	-	-	-	2JA_150_
3-4	5-8	1-2	2P5A_-120/4_	2P5SA_-120/4_	2JA_146_	2JXF_146_	-
		3	2P5A_-120/4_	2P5SA_-120/4_	2JAM_150_	-	-
		4	2P5A_-150/5_	2P5SA_-150/5_	2JAM_200	-	2JA_150_
		5	2P5A_-150/5_	2P5SA_-150/5_	2JAM_200	-	2JA_150_
		6	2P5A_-150/5_	2P5SA_-150/5_	2JAM_300	-	2JA_200_
		7	-	-	2JAM_300	-	2JA_200_
		8	-	-	-	-	2JA_300_

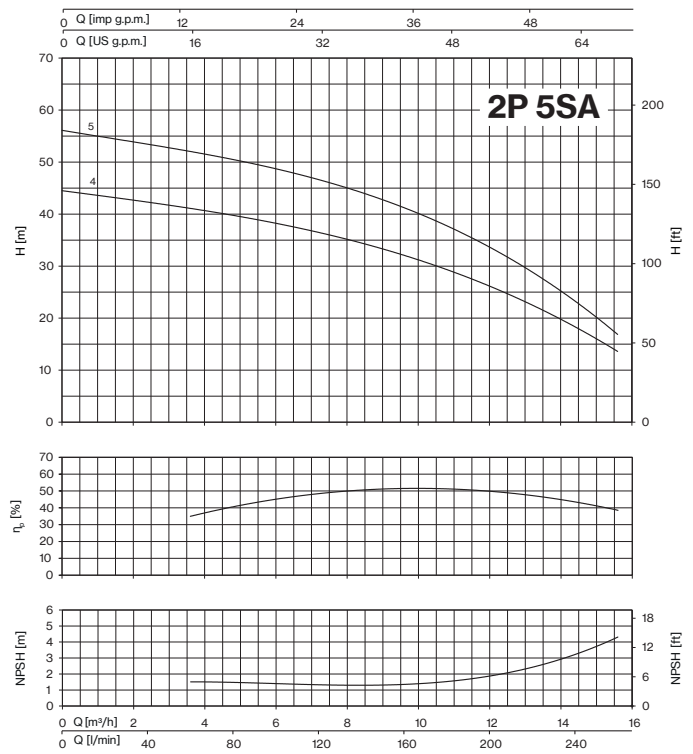
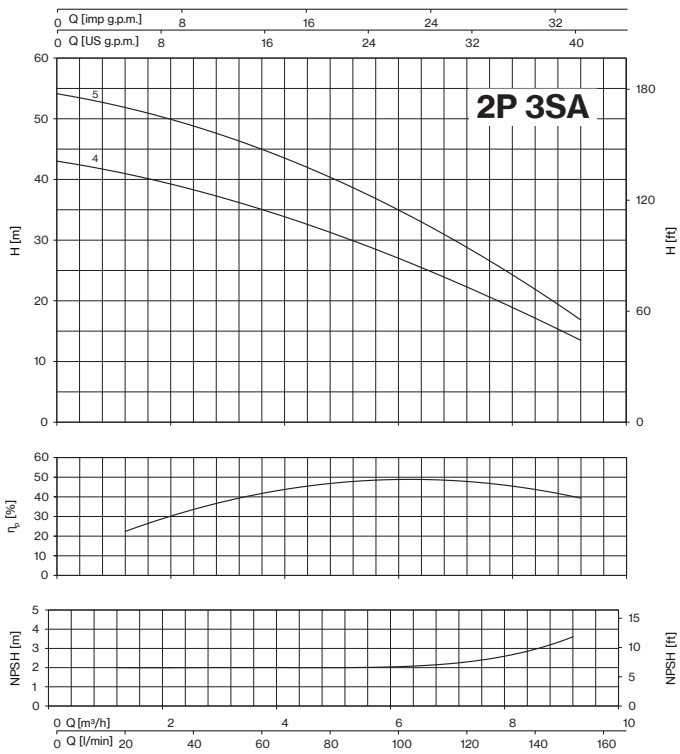
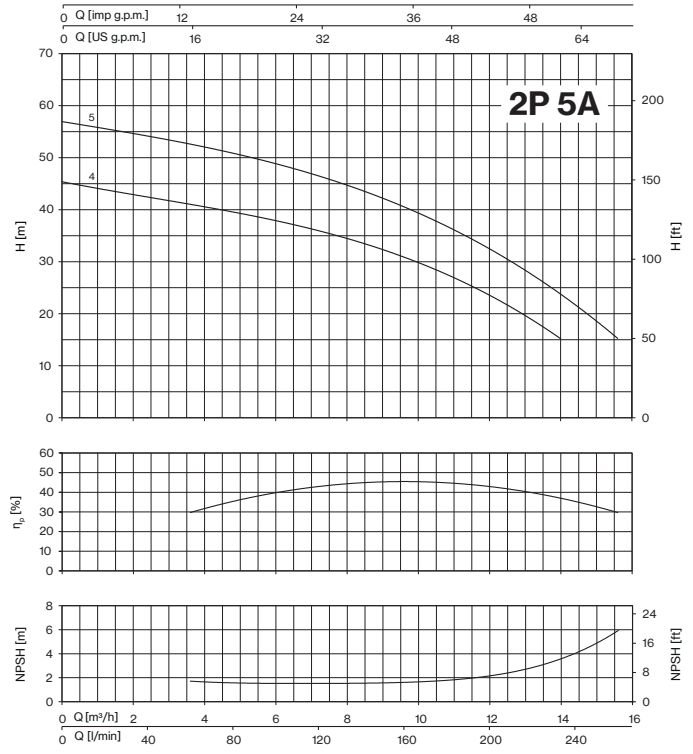
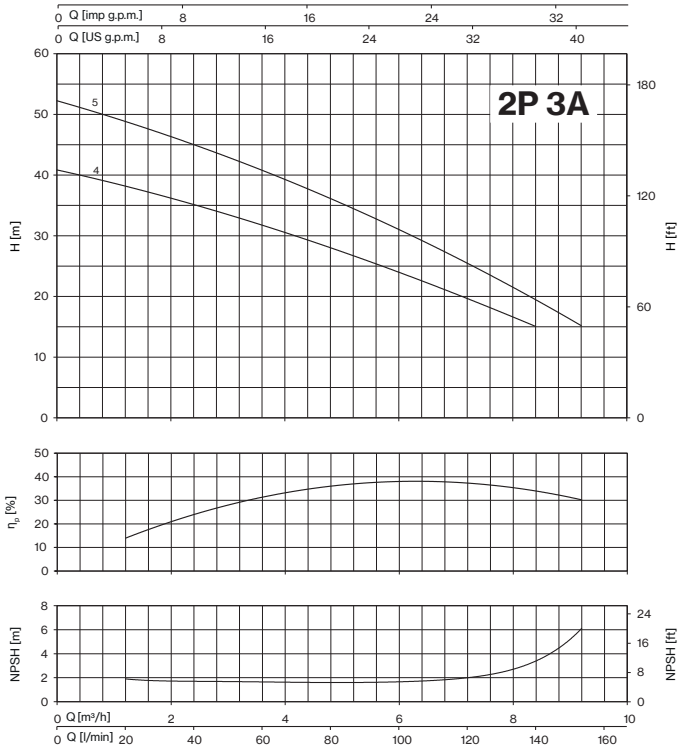

2P A / SA

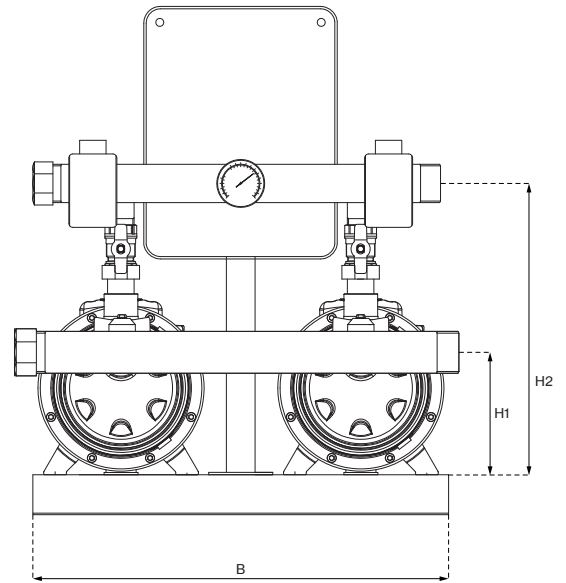
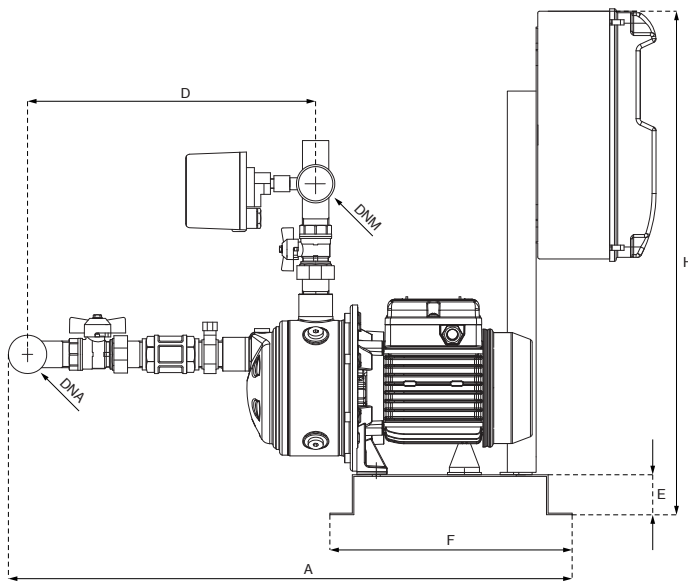

MODEL			P1		In			Required tank for v.s.	DIMENSIONS										WEIGHT	
FIXED SPEED		VARIABLE SPEED	1~	3~	1~ 230V	3~ 400V	3~ 230V		A	B	D	E	F	H	H1	H2	DNA	DNM	f.s.	v.s.
1- 230V	3- 400V	1- 230V-in 3- 230V-out																		
2P3A-90/4	2P3A-90/4T	2P3A/E-90/4T	0,9	0,88	4	1,8	3,1	2x 8	829	560	453	40	350	545	128	333	2" G	1" 1/2 G	41	46
2P3SA-90/4	2P3SA-90/4T	2P3SA/E-90/4T	0,83	0,8	3,6	1,7	2,9	2x 8	853	560	477	40	350	545	128	333			46	51
2P3A-100/5	2P3A-100/5T	2P3A/E-100/5T	1,06	1,01	4,8	1,9	3,3	2x 8	853	560	477	40	350	545	128	333			46	51
2P3SA-100/5	2P3SA-100/5T	2P3SA/E-100/5T	0,99	0,92	4,4	1,7	2,9	2x 20	829	560	453	40	350	545	128	333			46	51
2P5A-120/4	2P5A-120/4T	2P5A/E-120/4T	1,13	1,13	5,2	2,5	4,3	2x 20	829	560	453	40	350	545	128	333			46	51
2P5SA-120/4	2P5SA-120/4T	2P5SA/E-120/4T	1,09	1,08	4,9	2,4	4,2	2x 20	853	560	477	40	350	545	128	333			52	57
2P5A-150/5	2P5A-150/5T	2P5A/E-150/5T	1,47	1,39	6,8	2,8	4,9	2x 20	853	560	477	40	350	545	134	339			52	57
2P5SA-150/5	2P5SA-150/5T	2P5SA/E-150/5T	1,39	1,31	6,5	2,7	4,7	2x 20	853	560	477	40	350	545	134	339			52	57

f.s. : fixed speed
v.s. : variable speed